

**Legend**

Finished Contours  
-25.0-

Cut Area

Fill Area

Edge of House Pad

Average FSL =  
Average Finished  
Surface Level

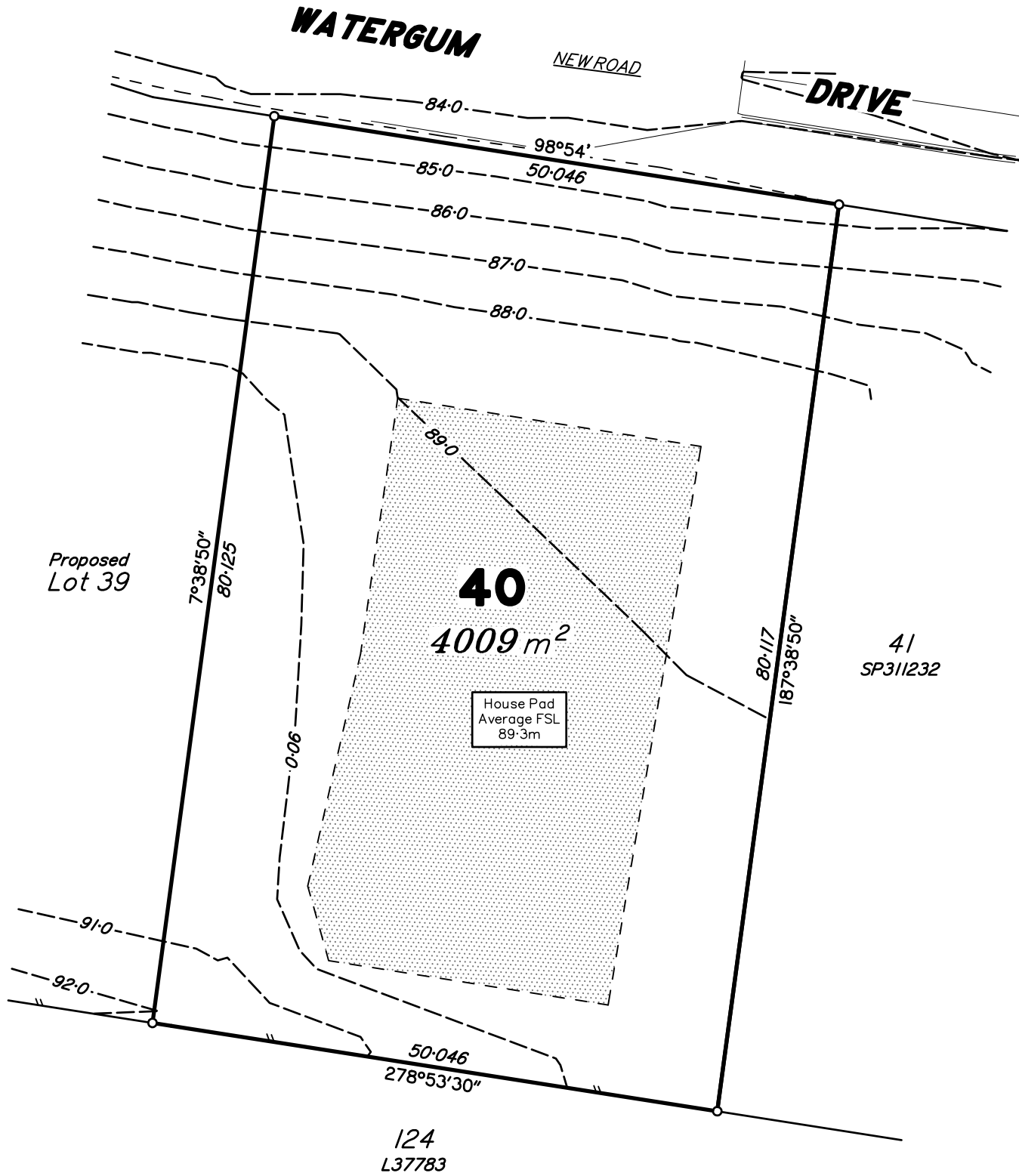

Scale 1:500 - Lengths are in Metres.

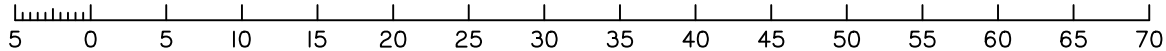

**Certification of Proposed Allotment 40 Details**

This plan illustrates Proposed Lot 40 as approved by Gympie Regional Council Development Approval file: DA13180, dated 7/11/2006 for Reconfiguration of a Lot (Stage 4), change to a development approval dated 23/03/2016, and change to development approval dated 16/09/2019, and a change to Development Application dated 25/07/2020. Also in accordance with Operational Works Approval No. 2020-0897 dated 17/07/2020 and Haynes Consulting Engineers Drawing series for Greendale Stage 4 Plans 1803-GS4 sheets 1-15 and subsequent sheets and amendments as approved by Gympie Regional Council.

**Notes**

1. Contours shown are Final Design levels derived from Detail Survey, conducted on 20/08/2020 and are shown at 1.0m intervals. Contours are not suitable for building design purposes.
2. All areas and dimensions are subject to council sealing of the Survey Plan and registration in the Department of Natural Resources and Mines.
3. This Plan is to be used as an attachment under the Land Sales Act 1984 to sell Freehold Land off the Plan.
4. Compaction of any fill material placed on this site shall be completed under inspection and testing services in accordance with AS3798-2007.

**MURRAY & ASSOCIATES**



SURVEYORS & TOWN PLANNERS

ACN 075 543 154

Murray Building, 15-17 Currie St. Nambour Ph. (07)5441 2188 P.O. Box 246  
Branch Offices at Caboolture Chinchilla Roma Gympie & Emerald

CADASTRAL SURVEYOR

*J.K.S.*

**DISCLOSURE PLAN**

**Disclosure Plan for Proposed Lot 40**  
(Currently part of Lot 500 on SP311232)

CLIENT: **Roberts Brothers**

DATE: 24/08/2020

SCALE: 1:500

COMP FILE: 61994\_(Disclosure) Roberts.dwg

Level Datum: PSM177674 RL89-974m AHD(D)

MAP REF: 9445-43222

ORIGINAL: POR 366V

CONTOUR INT: 1.0m

DRAWN: LF

JOB No:

CHECKED: IKS

**61994/40**

LOCAL AUTHORITY: GYMPIE REGIONAL COUNCIL

LOCALITY: Pie Creek