

Haynes Consulting Engineers Pty Ltd
ABN No. 53613630078
P.O Box 549 Noosa Heads 4567

Ph: 0432 784 150



LEVEL 2 CERTIFICATION:

**10 Lots at Stage 2B Greendale Downs, Watergum Drive and Applewood Place, Pie Creek
Proposed Lots 52, 53, 55, 93, 94, 95, 96, 97
Proposed lots currently part of Existing Lot 500 SP246422**

CONTENTS

CERTIFICATION LETTER

LIMITATIONS

TEST LOCATIONS

TEST RESULTS

BACKGROUND

Plans G18047-Ascon dated 16-8-18, Plans S1-S6 inclusive revision 0
Compaction tests G18032-1 to G18032-7 inclusive, G18032-11, G18032-15
Cross sections 1927-106E, 1927-107E

To: Roberts Bros. Pty Ltd
(by email)

LEVEL 2 CERTIFICATION

10 Lots at Stage 2B Greendale Downs, Watergum Drive and Applewood Place, Pie Creek
Proposed Lots 52, 53, 55, 93, 94, 95, 96, 97
Proposed lots part of Existing Lot 500 SP246422

This letter provides Level 2 certification to AS3798-2007 'Guidelines on earthworks for commercial and residential developments' and includes the results of testing conducted during filling earthworks on proposed Lots 52, 53, 55, 93, 94, 95, 96, and 97 (8 lots). There were 13 lots in stage 2B, lots 98, 99, 100, 101 and 54 (5 lots) were not filled as part of Roberts Bros Pty Ltd works so no testing was completed.

These lots are on a balance area of land subdivided by others (Lot 500 SP246422). In previous bulk earthworks there was road formation fill at the high side of lots 52, 53, 54, 55, and low side of lots 101 and 96 (CH1100-1310, refer to plans S2, S4, and S6 for location). Previous Operational Works 2008-0190 indicates extent of fill on cross sections 1927-106 Rev E, 1927-107 Rev E attached for information only. Haynes Consulting Engineers were not involved with any previous earthworks on these lots and as such takes no responsibility for any previous work, refer to report limitations for further information. Our Client Roberts Bros Pty Ltd purchased balance area Lot 500 SP246422 and completed cut to fill house pads which is the basis of this report.

Roberts Brothers Pty Ltd personnel and sub-contractors undertook the cut to fill and compaction using existing site material to create house pads.

Inspections of surface stripping (to remove organic topsoil), removal of unsuitable materials and subgrade proof rolling prior to filling were completed.

Determination of field density of compacted fill in accordance with AS1289 was completed by Geotech SC Pty Ltd as attached,

- Report Nos G18032-1/1 dated 28-3-2018
- Report No G18032-2/1 dated 29-3-2018
- Report No G18032-3/1 dated 4-4-2018
- Report No G18032-4/1 dated 16-4-2018
- Report No G18032-5/1 dated 16-4-2018
- Report No G18032-6/1 dated 8-5-2018
- Report No G18032-7/2 dated 10-5-2018
- Report No G18032-11/1 dated 29-5-2018
- Report No G18032-15/1 dated 12-7-2018

The compaction tests show that results were above the required 95% Standard Compaction. Test locations are shown on the attached plans S1, S2, S3, S4, S5, and S6 which are all Revision 0.

This certification only provides an assurance of the density of the fill tested, and suitability of the stripped surface for placement of that fill. This certification does not address any other issues that may be relevant to foundation and building construction.

Please refer to report limitations attached, the Client in this instance is Roberts Brothers Pty Ltd.

Regards,

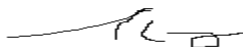

A Haynes BE Civil (Hons) RPEQ MIEAust CPEng

LIMITATIONS

This report is provided for the sole use by the Client and its professional advisers. No responsibility whatsoever for the contents of this report will be accepted to any person other than the Client. Any use which a third party makes of this report, or any reliance on or decisions to be made based on it, is the responsibility of such third parties. Haynes Consulting Engineers accepts no responsibility for damages, if any, suffered by any third party as a result of decisions made or actions based on this report.

Haynes Consulting Engineers did not perform a complete assessment of all possible conditions or circumstances that may exist at the site referenced in the report. If a service is not expressly indicated, do not assume it has been provided. If a matter is not addressed, do not assume that any determination has been made by Haynes Consulting Engineers in regards to it.

Conditions may exist which were undetectable given that economic and time constraints limit the practical extent of investigation. Variations in conditions may occur between investigation locations, and there may be special conditions pertaining to the site which have not been revealed by the investigation and which have not therefore been taken into account in the report.

Where variations exist on site, additional studies and actions may be required. Haynes Consulting Engineers's opinions are based upon information that existed at the time that the works were performed. The passage of time, man-made or natural events, may alter the site conditions. It is understood that the Services undertaken allowed Haynes Consulting Engineers to form an opinion of the actual conditions of the site at the time the site was visited and cannot be used to assess the effect of any subsequent changes in the quality of the site, or its surroundings, or any laws or regulations.

Any assessments made in this report are based on the conditions indicated from published sources and the findings of the investigation described. Actual subsurface conditions may differ from those indicated in the report (e.g. between boreholes or test pits). No warranty is included, either express or implied, that the actual conditions will conform exactly to the assessments contained in this report.

Where data supplied by the client or other external sources, including previous site investigation data, have been used, it has been assumed that the information is correct unless otherwise stated. No responsibility is accepted by Haynes Consulting Engineers for incomplete or inaccurate data supplied by others.

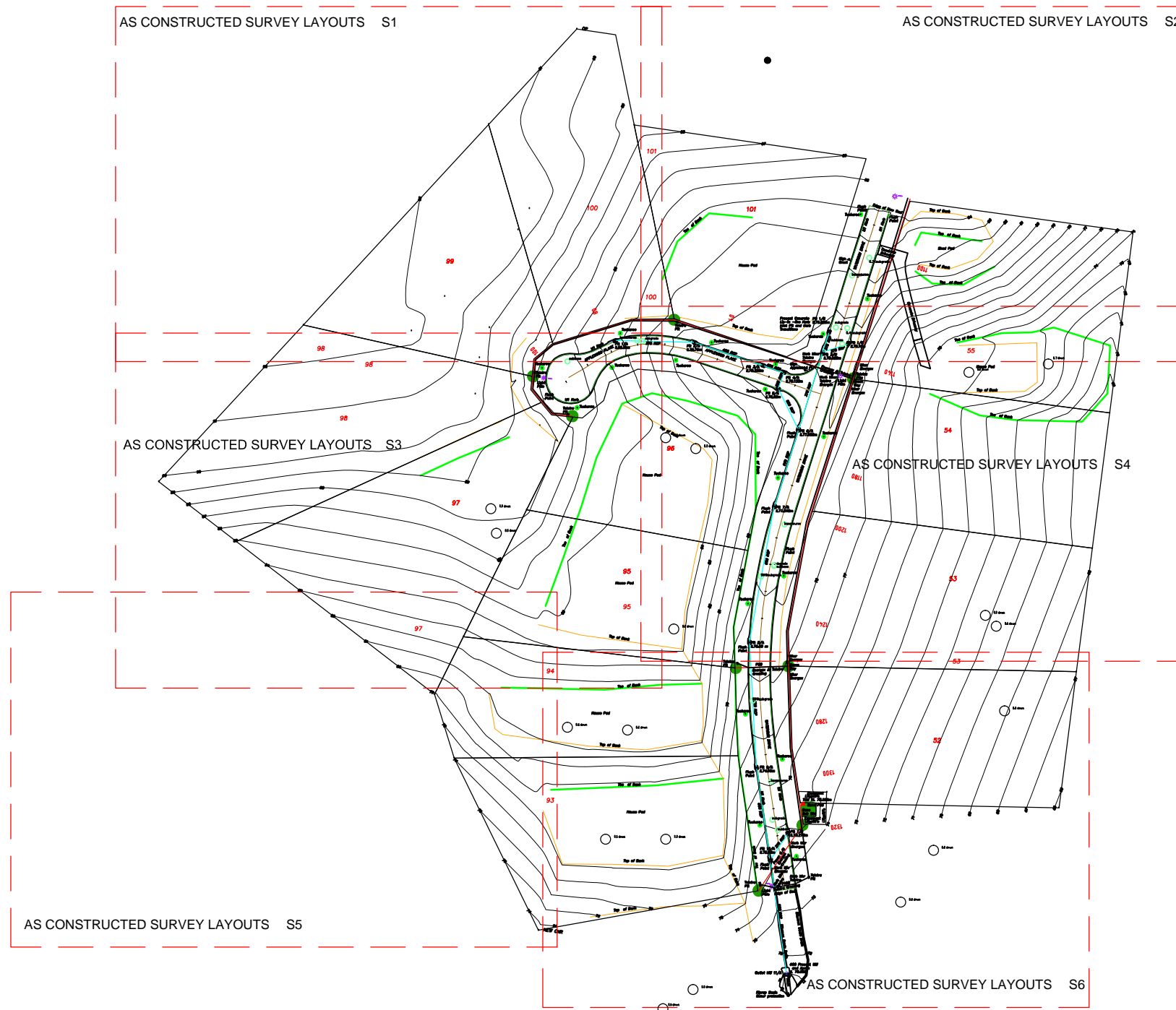

CERTIFIED BY: 
 RPEQ No.: 13201 (Allister Haynes)
 DATE: 16 / 8 / 2018

This drawing is an accurate representation of the works as-constructed. All the locations and levels shown on this plan have been provided by a Surveyor as defined in the Surveyors Act 2003. I hereby accept responsibility for the as-constructed information shown on this plan.



Noosa Cooloola Land Surveys Pty Ltd
 Consulting Land Surveyors
 ACN 613974486
 P.O. Box 1684, Noosa Heads, QLD. 4567

Mike Campbell 0412 603286
 David Lau 0419 782360
 Greg Martoo 0409 632830



NOTE
 LEVEL DATUM – PSM177681 RL86.521 AHD D
 CONTOUR INTERVAL – Major 2.0m, Minor 0.5m.

Asconstructed Survey
 Greendale Stage 2b
 Lot 500 on SP246422

PARISH —
 COUNTY —
 LOCALITY *Pie Creek*
 ORIGINAL —

SCALE 1:1000/A1
 DATE 16/08/2018
 DRAWN PS
 DRAWING 18047-Ascon

LEGEND:

-  APPROXIMATE ALLOTMENT FILL COMPACTION TEST LOCATION AND DEPTH BELOW FINISHED LEVEL
-  APPROXIMATE TEST LOCATION AND TYPE

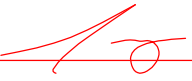
CERTIFIED BY: 

RPEQ No.: 13201 (Allister Haynes)
 DATE: 16 / 8 / 2018

This drawing is an accurate representation of the works as-constructed. All the locations and levels shown on this plan have been provided by a Surveyor as defined in the Surveyors Act 2003. I hereby accept responsibility for the as-constructed information shown on this plan.



0 5 10 15m Scale 1:500 @A3

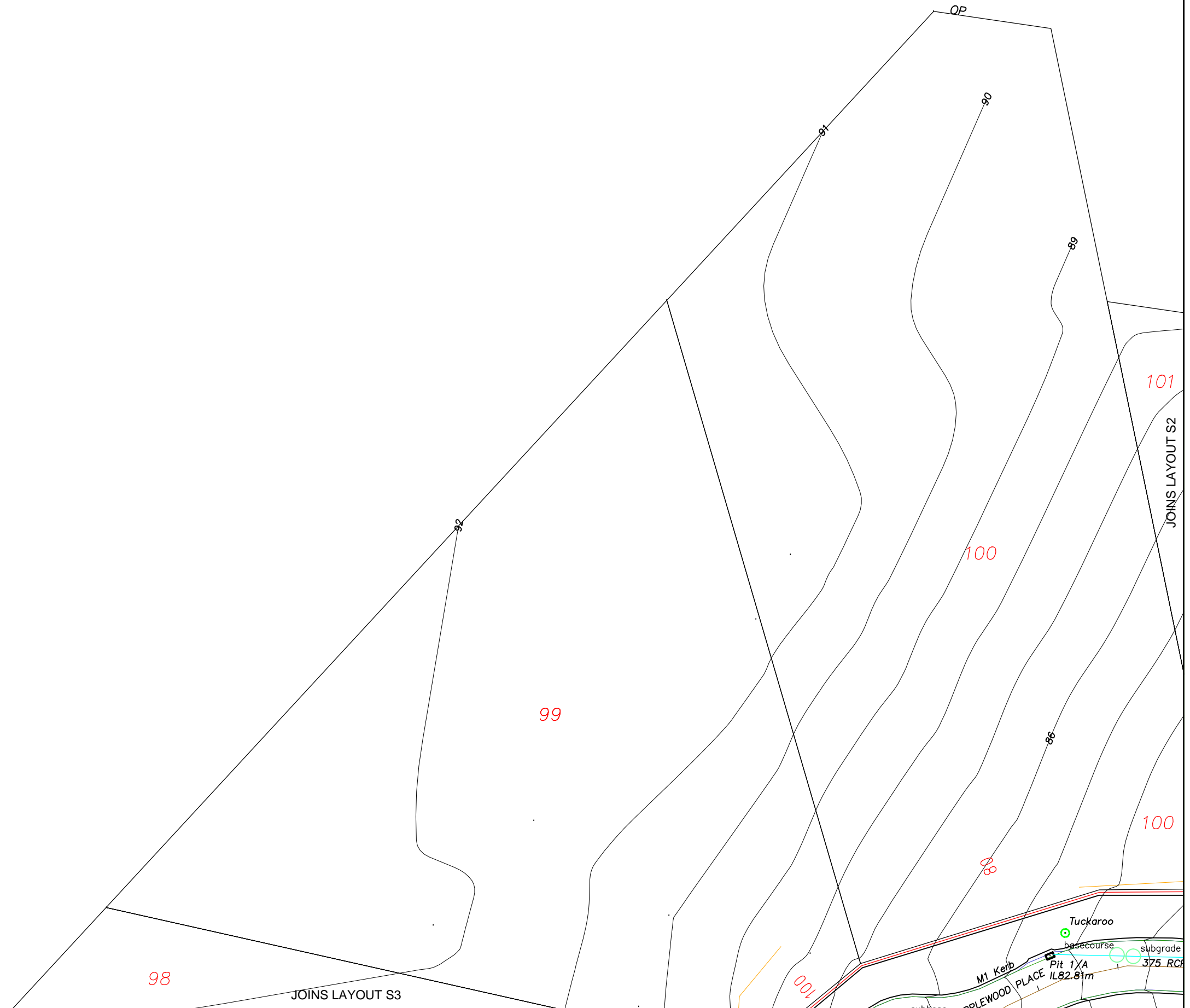

A3

0	16-8-18	AS CONSTRUCTED	ATH
Rv	DATE	REVISIONS	APPR.

PSM No	177681
(AHD) RL	86.521
SURVEYED	Noosa Cooloola Land Surveys



HAYNES CONSULTING ENGINEERS

HAYNES CONSULTING ENGINEERS
 ABN 53 613 630 078
 PO BOX 549 NOOSA HEADS QLD 4567
 (0432) 784 150

GREENDALE DOWNS STAGE 2B
 Lot 500 on SP246422
 Surveyed by Noosa Cooloola Land Surveys Pty Ltd
AS CONSTRUCTED SURVEY LAYOUTS

1803
Sheet No. - Revision No.
S1 0

CERTIFIED BY: 
 RPEQ No.: 13201 (Allister Haynes)
 DATE: 16 / 8 / 2018

This drawing is an accurate representation of the works as-constructed. All the locations and levels shown on this plan have been provided by a Surveyor as defined in the Surveyors Act 2003. I hereby accept responsibility for the as-constructed information shown on this plan.

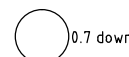
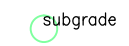

LEGEND:
 APPROXIMATE ALLOTMENT FILL COMPACTION TEST LOCATION AND DEPTH BELOW FINISHED LEVEL
 APPROXIMATE TEST LOCATION AND TYPE

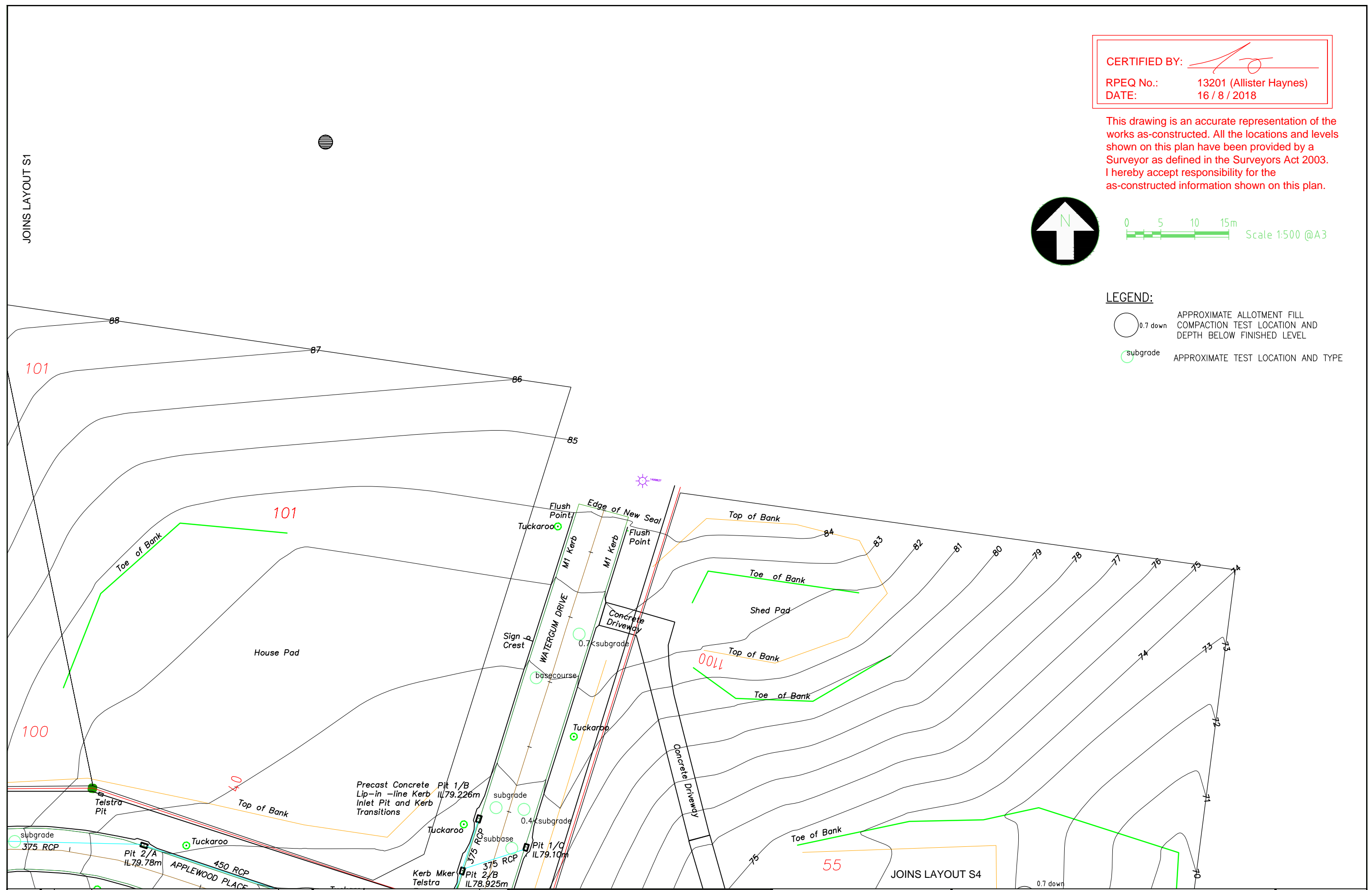

A3	0	16-8-18	AS CONSTRUCTED	ATH
	Rv	DATE	REVISIONS	APPR.

PSM No	177681
(AHD) RL	86.521
SURVEYED	Noosa Cooloola Land Surveys



HAYNES CONSULTING ENGINEERS
 ABN 53 613 630 078
 PO BOX 549 NOOSA HEADS QLD 4567
 (0432) 784 150

GREENDALE DOWNS STAGE 2B
 Lot 500 on SP246422
 Surveyed by Noosa Cooloola Land Surveys Pty Ltd
 AS CONSTRUCTED SURVEY LAYOUTS

1803	Sheet No. - Revision No.
S2	0

LEGEND:

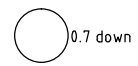
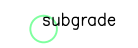
-  APPROXIMATE ALLOTMENT FILL COMPACTION TEST LOCATION AND DEPTH BELOW FINISHED LEVEL
-  APPROXIMATE TEST LOCATION AND TYPE

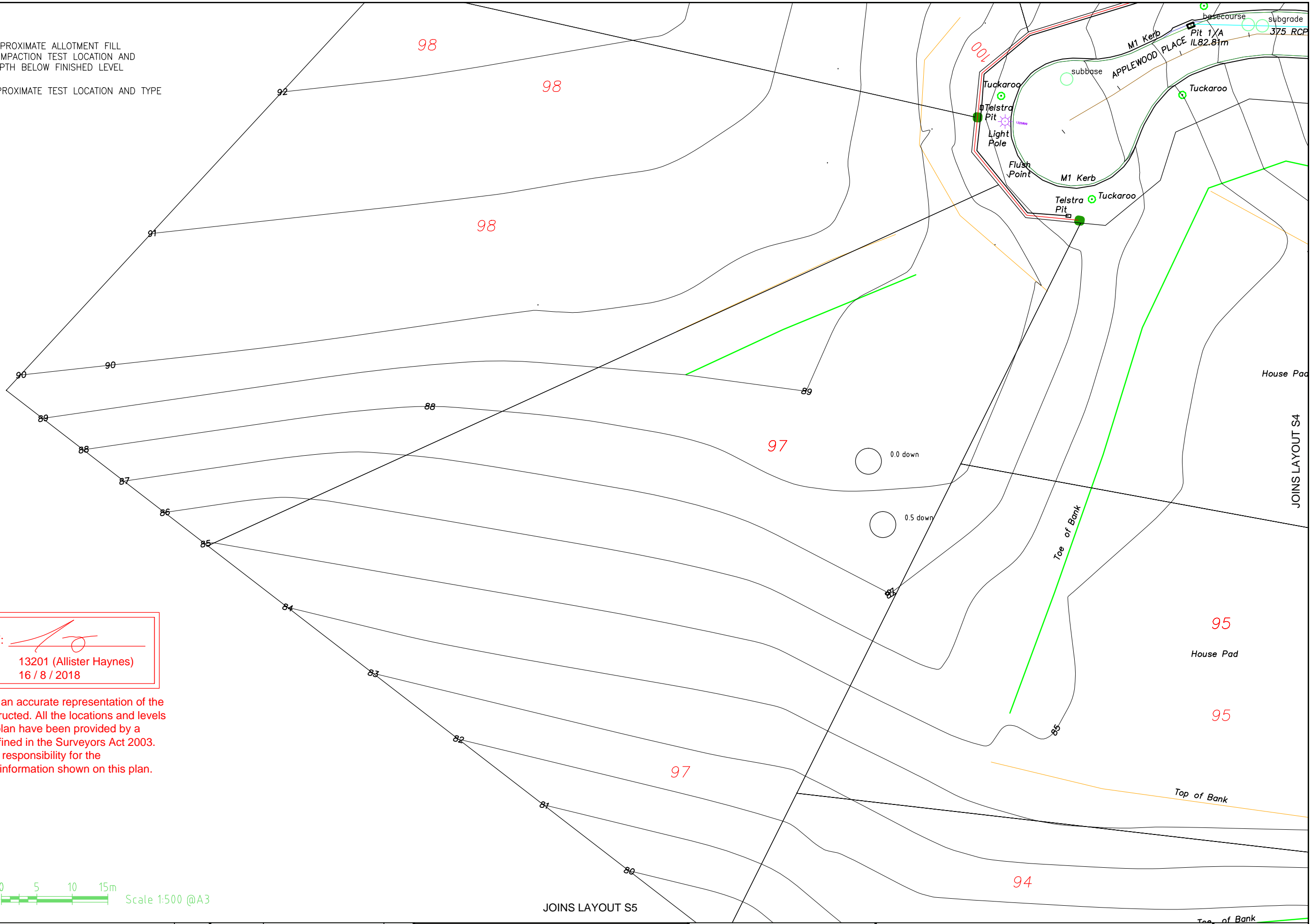

CERTIFIED BY: 
RPEQ No.: 13201 (Allister Haynes)
DATE: 16 / 8 / 2018

This drawing is an accurate representation of the works as-constructed. All the locations and levels shown on this plan have been provided by a Surveyor as defined in the Surveyors Act 2003. I hereby accept responsibility for the as-constructed information shown on this plan.



 Scale 1:500 @A3

A3

0	16-8-18	AS CONSTRUCTED	ATH
Rv	DATE	REVISIONS	APPR.

PSM No	177681
(AHD) RL	86.521
SURVEYED	Noosa Cooloola Land Surveys



HAYNES CONSULTING ENGINEERS
 ABN 53 613 630 078
 PO BOX 549 NOOSA HEADS QLD 4567
 (0432) 784 150

GREENDALE DOWNS STAGE 2B
 Lot 500 on SP246422
 Surveyed by Noosa Cooloola Land Surveys Pty Ltd
AS CONSTRUCTED SURVEY LAYOUTS

1803
 Sheet No. - Revision No.
S3 0

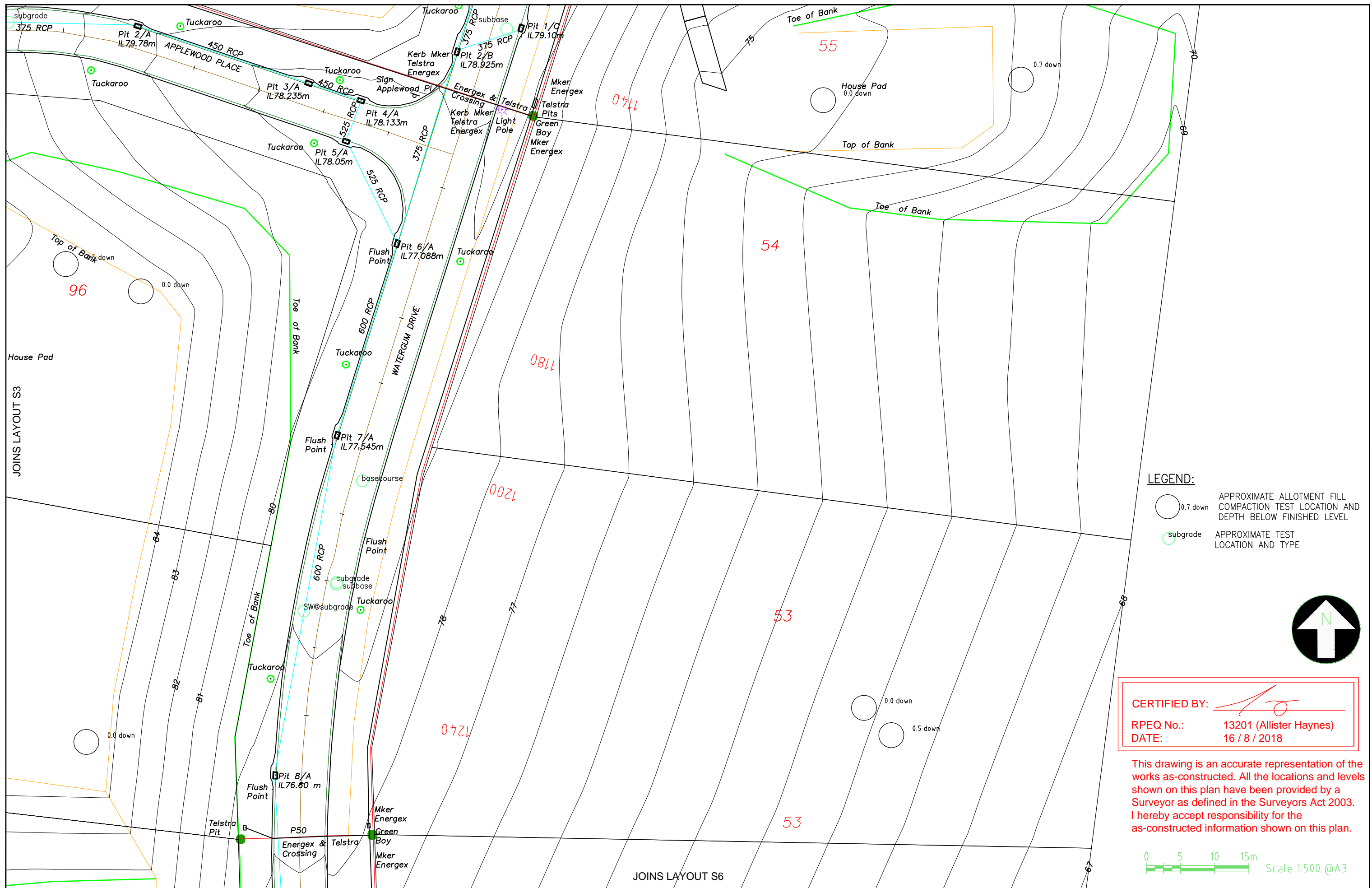

LEGEND:

○ 0.7 down APPROXIMATE ALLOTMENT FILL COMPACTION TEST LOCATION AND DEPTH BELOW FINISHED LEVEL

○ subgrade APPROXIMATE TEST LOCATION AND TYPE

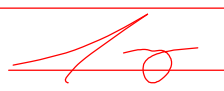

CERTIFIED BY: 

RPEQ No.: 13201 (Allister Haynes)

DATE: 16 / 8 / 2018

This drawing is an accurate representation of the works as-constructed. All the locations and levels shown on this plan have been provided by a Surveyor as defined in the Surveyors Act 2003. I hereby accept responsibility for the as-constructed information shown on this plan.

0 5 10 15m Scale 1:500 @A3

A3	0	16-8-18	AS CONSTRUCTED	ATH
	Rv	DATE	REVISIONS	APPR.

PSM No	177681
(AHD) RL	86.521
SURVEYED	Noosa Cooloola Land Surveys

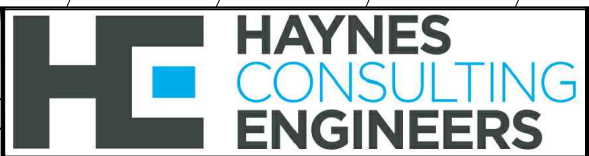

HAYNES CONSULTING ENGINEERS
 ABN 53 613 630 078
 PO BOX 549 NOOSA HEADS QLD 4567
 (0432) 784 150

GREENDALE DOWNS STAGE 2B
 Lot 500 on SP246422
 Surveyed by Noosa Cooloola Land Surveys Pty Ltd
AS CONSTRUCTED SURVEY LAYOUTS

1803	Sheet No. - Revision No.
S4	0

JOINS LAYOUT S3

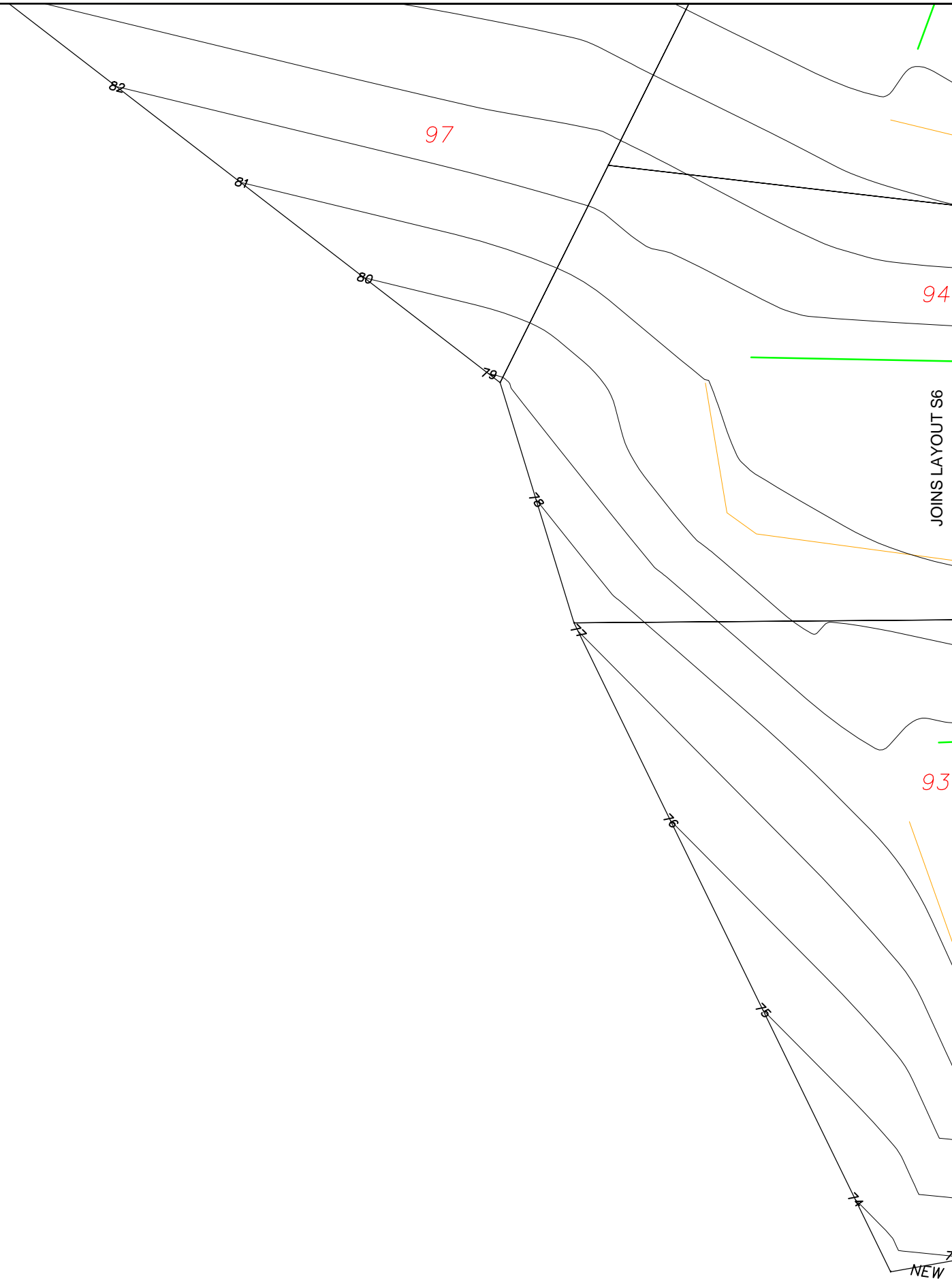

LEGEND:

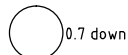
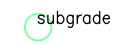
-  APPROXIMATE ALLOTMENT FILL COMPACTION TEST LOCATION AND DEPTH BELOW FINISHED LEVEL
-  APPROXIMATE TEST LOCATION AND TYPE

CERTIFIED BY: 

RPEQ No.: 13201 (Allister Haynes)
 DATE: 16 / 8 / 2018

This drawing is an accurate representation of the works as-constructed. All the locations and levels shown on this plan have been provided by a Surveyor as defined in the Surveyors Act 2003. I hereby accept responsibility for the as-constructed information shown on this plan.



0 5 10 15m Scale 1:500 @A3

A3

0	16-8-18	AS CONSTRUCTED	ATH
Rv	DATE	REVISIONS	APPR.

PSM No	177681
(AHD) RL	86.521
SURVEYED	Noosa Cooloola Land Surveys



HAYNES CONSULTING ENGINEERS
 ABN 53 613 630 078
 PO BOX 549 NOOSA HEADS QLD 4567
 (0432) 784 150

GREENDALE DOWNS STAGE 2B
 Lot 500 on SP246422
 Surveyed by Noosa Cooloola Land Surveys Pty Ltd
AS CONSTRUCTED SURVEY LAYOUTS

1803
Sheet No. - Revision No.
S5 0

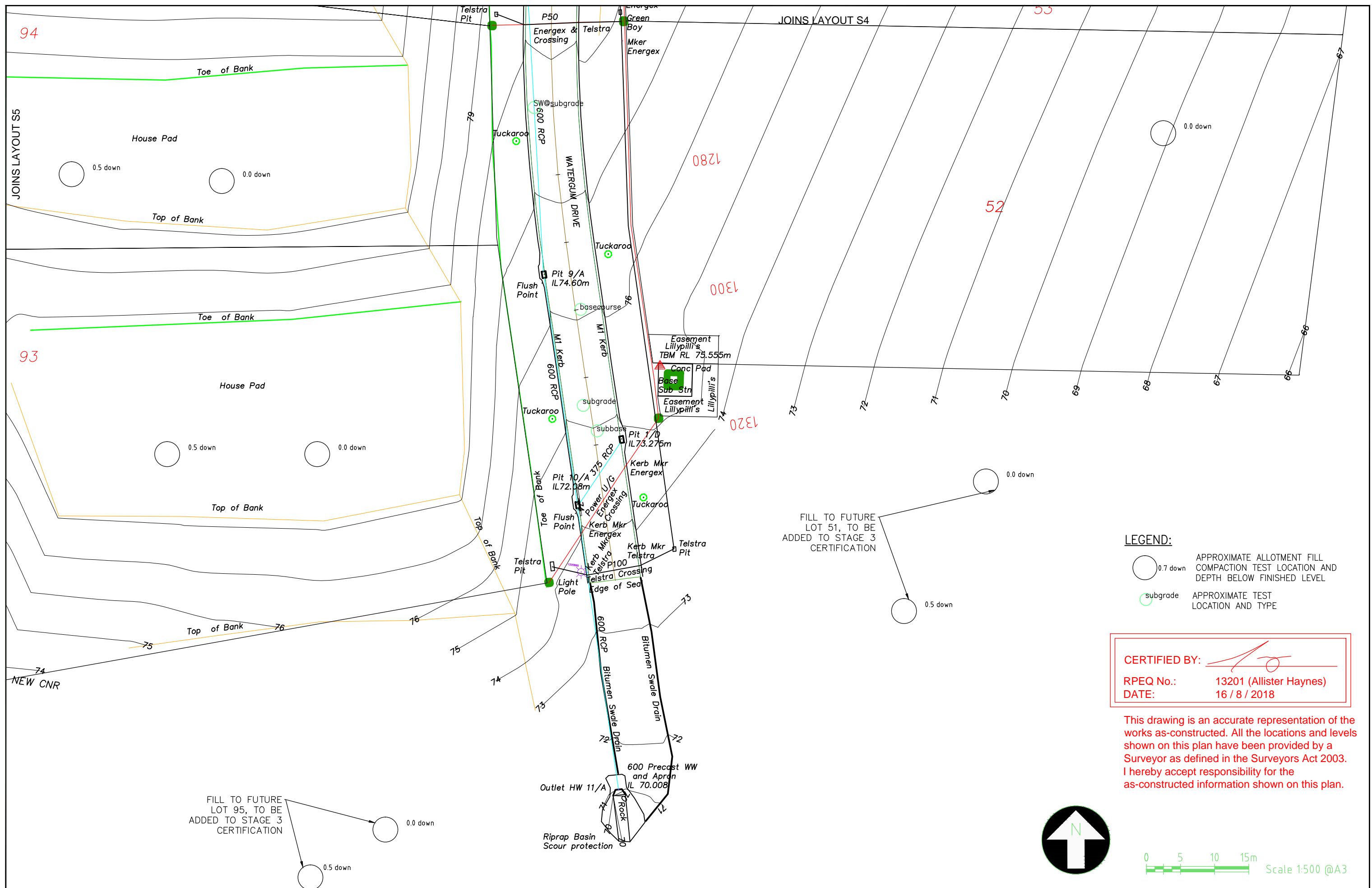

LEGEND:

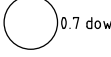
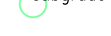
-  APPROXIMATE ALLOTMENT FILL COMPACTION TEST LOCATION AND DEPTH BELOW FINISHED LEVEL
-  APPROXIMATE TEST LOCATION AND TYPE

CERTIFIED BY: 

RPEQ No.: 13201 (Allister Haynes)
DATE: 16 / 8 / 2018

This drawing is an accurate representation of the works as-constructed. All the locations and levels shown on this plan have been provided by a Surveyor as defined in the Surveyors Act 2003. I hereby accept responsibility for the as-constructed information shown on this plan.

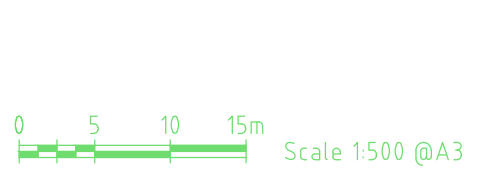

A3	0	16-8-18	AS CONSTRUCTED	ATH
	Rv	DATE	REVISIONS	APPR.

PSM No	177681
(AHD) RL	86.521
SURVEYED	Noosa Cooloola Land Surveys



HAYNES CONSULTING ENGINEERS
 ABN 53 613 630 078
 PO BOX 549 NOOSA HEADS QLD 4567
 (0432) 784 150

GREENDALE DOWNS STAGE 2B
 Lot 500 on SP246422
 Surveyed by Noosa Cooloola Land Surveys Pty Ltd
AS CONSTRUCTED SURVEY LAYOUTS

1803	Sheet No. - Revision No.
S6	0