

Scale 1:600 - Lengths are in metres.

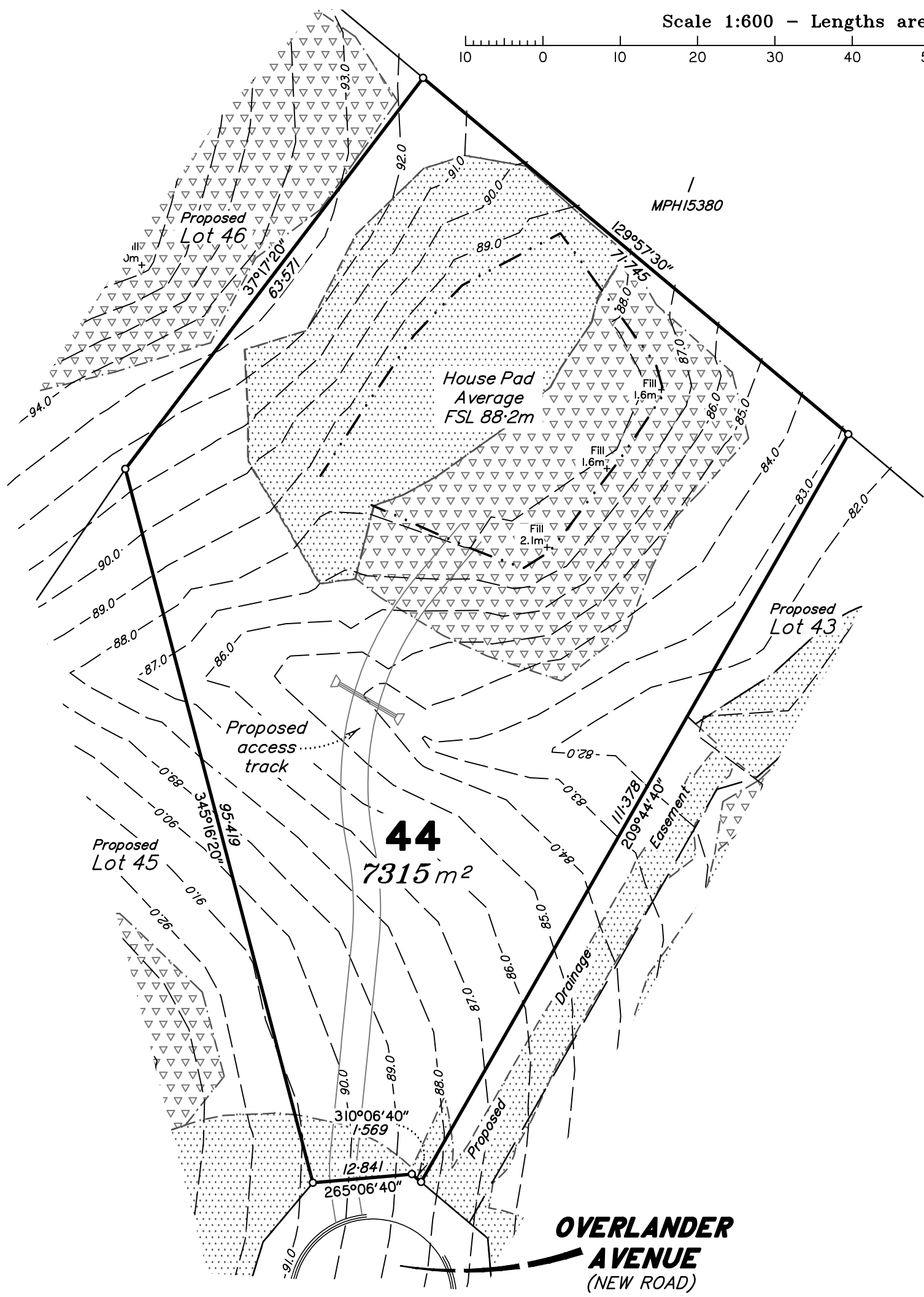
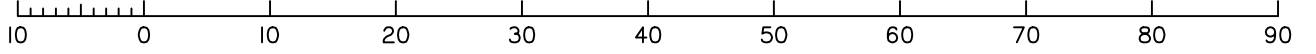

Legend

- Finished Contours - 25.0
- Edge of House Pad
- Kerb & Channel
- Cut Area
- Fill Area

Certification of Proposed Allotment 44 Details

This plan illustrates Proposed Lot 44 as approved by Gympie Regional Council Development Approval file: DA15764, dated 11/2/2009 for Material Change of Use and Reconfiguration of a lot and the Decision Notice - Change Application (Minor) dated 8/10/2020, and in accordance with Operational Works Development Permit No.2021-0713 and Haynes Consulting Engineers Drawings contained within that permit and subsequent sheets and amendments as approved by Gympie Regional Council.

- Notes**
1. Contours shown are Final Design levels derived from Detail Survey, conducted on 6/7/2021 and are shown at 1.0m intervals. Contours are not suitable for building design purposes.
 2. All areas and dimensions are subject to council sealing of the Survey Plan and registration in the Department of Resources.
 3. This Plan is to be used as an attachment under the Land Sales Act 1984 to sell Freehold Land off the Plan.
 4. All dimensions and areas are subject to final registration of the Survey Plan.
 5. Compaction of any fill material placed on this site shall be completed under inspection and testing services in accordance with AS3798-2007.

<p>MURRAY & ASSOCIATES SURVEYORS & TOWN PLANNERS ACN 075 543 154 Murray Building, 15-17 Currie St. Nambour Ph. (07)5441 2188 P.O. Box 246 Branch Offices at Caboolture Chinchilla Roma Gympie & Emerald CADASTRAL SURVEYOR</p>	<p>DISCLOSURE PLAN</p> <p>Disclosure Plan for Proposed Lot 44</p> <p>(Currently part of Lot 35 on SP300760)</p>		<p>CLIENT: Roberts Bros</p>
	<p>LOCAL AUTHORITY: GYMPIE REGIONAL COUNCIL LOCALITY: Chatsworth</p>	<p>DATE: 22/7/2021</p> <p>COMP FILE: 60425_(Stage 3 Disclosures)_QTM.dwg</p> <p>MAP REF: 9445-42443</p> <p>CONTOUR INT: 1.0 m</p> <p>DRAWN: AJH</p> <p>CHECKED: IKS</p>	<p>SCALE @A3: 1:600</p> <p>Level Datum: PSM19093 RL85-373m AHD(D)</p> <p>ORIGINAL: POR 371</p> <p>JOB No: 42526/44</p>