

**Legend**

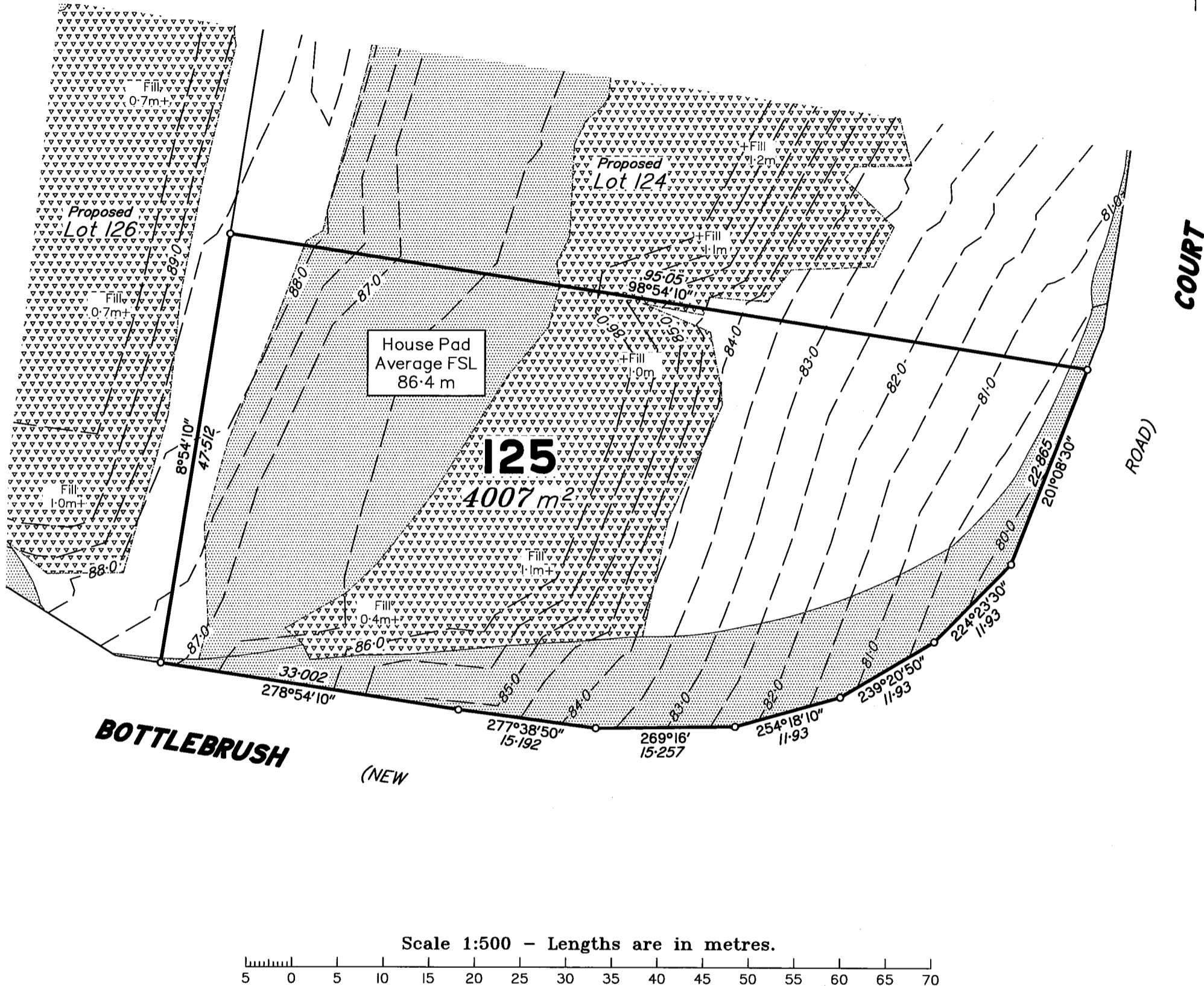
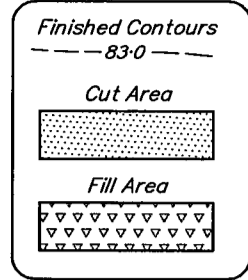

**Certification of Proposed Allotment 125 Details**

This plan illustrates Proposed Lot 125 as approved by Gympie Regional Council Development Approval file: 2008-0147, dated 7/01/2020 and in accordance with a subsequent change to an existing approval application in accordance with 'to be approved' plan by Murray & Associates being plan 61995B dated 15/11/2022. Also in accordance with Operational Works Development Permits No.2021-2428 dated 26/11/2021 and No.2021-2911 dated 30/03/2022 and Haynes Consulting Engineers Drawing Series for Job No.1803-GB6 and Job No.1803-GS6 contained within those permits and subsequent sheets and amendments as approved by Gympie Regional Council.

**Notes**

1. Contours shown are Existing Surface Contours derived from Detail Survey by Murray & Associates as at 23/01/2023 and are shown at 0.5m intervals. Contours are not suitable for building design purposes.
2. All areas and dimensions are subject to council sealing of the Survey Plan and registration in the Department of Resources.
3. This Plan is to be used as an attachment under the Land Sales Act 1984 to sell Freehold Land off the Plan.
4. Compaction of any fill material placed on this site shall be completed under inspection and testing services in accordance with AS3798-2007.

**MURRAY & ASSOCIATES**  
SURVEYORS & TOWN PLANNERS  
ACN 075 543 154  
Murray Building, 15-17 Currie St. Nambour Ph.(07)5441 2188 P.O. Box 246  
Branch Offices at Caboolture Chinchilla Roma Gympie & Emerald  
CADASTRAL SURVEYOR *G.K.S.*

**DISCLOSURE PLAN**  
**Disclosure Plan for Proposed Lot 125**  
**(Currently part of Lot 124 on SP329116)**  
LOCAL GYMPIE  
AUTHORITY: REGIONAL COUNCIL LOCALITY: Pie Creek

CLIENT: <b>Roberts Brothers</b>	
DATE: 25/01/2023	SCALE @A3: <b>1:500</b>
COMP 61995_(Stage 6 Dis)	Level OPM177674
FILE: _Roberts Bros.dwg	Datum: RL89-974m AHD(0)
MAP REF: 9445-34111	ORIGINAL: POR 366
CONTOUR INT: 0.5 m	
DRAWN: AJH	JOB No: <b>61995/125</b>
CHECKED: JKS	