

BOTTLEBRUSH (NEW ROAD) COURT

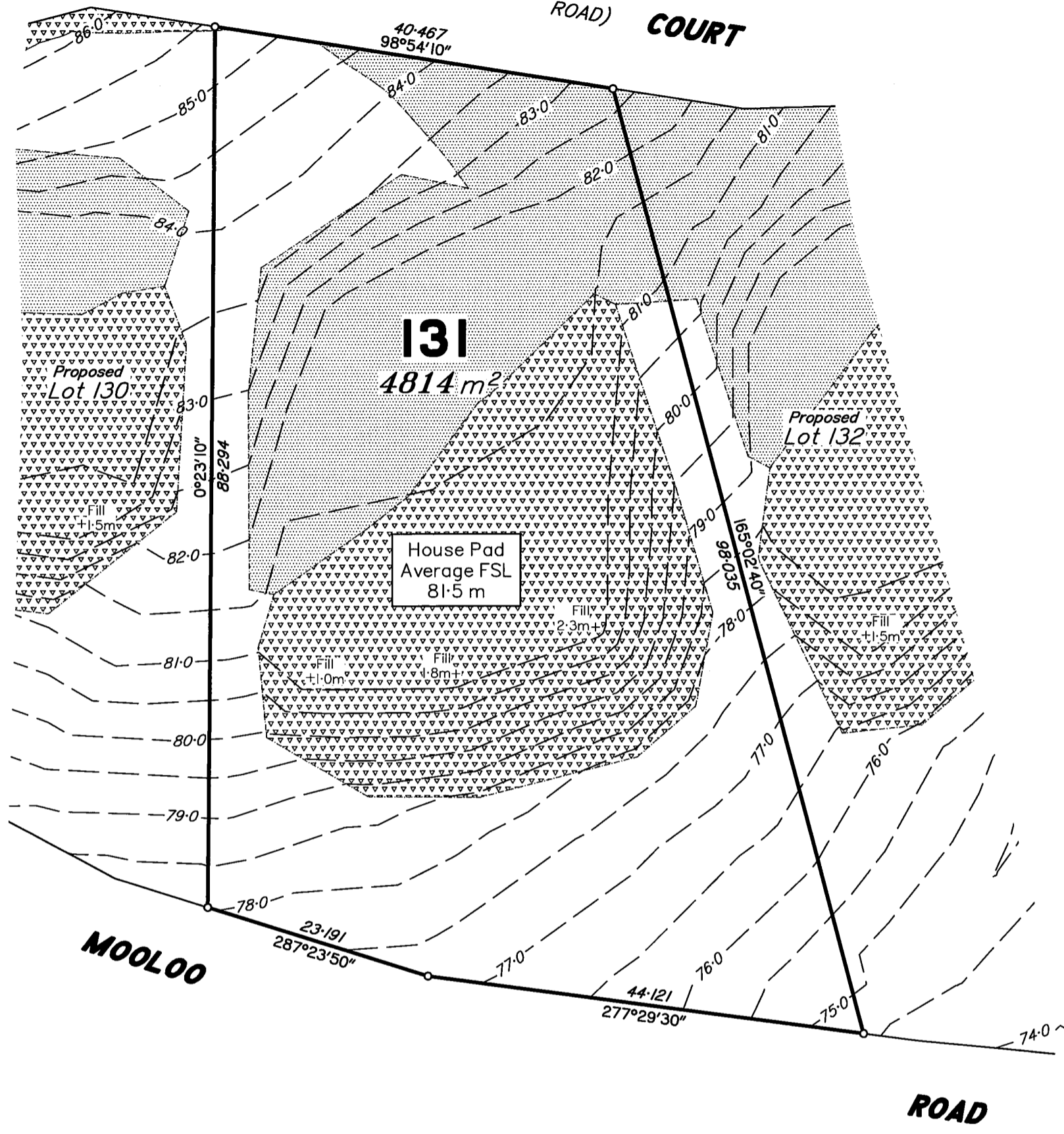

Legend

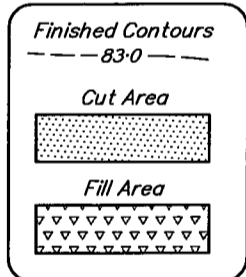

Scale 1:500 - Lengths are in metres.

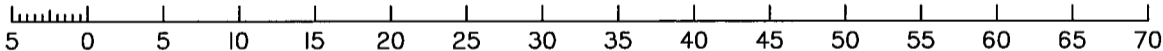

Certification of Proposed Allotment 131 Details

This plan illustrates Proposed Lot 131 as approved by Gympie Regional Council Development Approval file: 2008-0147, dated 7/01/2020 and in accordance with a subsequent change to an existing approval application in accordance with 'to be approved' plan by Murray & Associates being plan 61995B dated 15/11/2022. Also in accordance with Operational Works Development Permits No.2021-2428 dated 26/11/2021 and No.2021-2911 dated 30/03/2022 and Haynes Consulting Engineers Drawing Series for Job No.1803-GB6 and Job No.1803-GS6 contained within those permits and subsequent sheets and amendments as approved by Gympie Regional Council.

Notes

1. Contours shown are Existing Surface Contours derived from Detail Survey by Murray & Associates as at 23/01/2023 and are shown at 0.5m intervals. Contours are not suitable for building design purposes.
2. All areas and dimensions are subject to council sealing of the Survey Plan and registration in the Department of Resources.
3. This Plan is to be used as an attachment under the Land Sales Act 1984 to sell Freehold Land off the Plan.
4. Compaction of any fill material placed on this site shall be completed under inspection and testing services in accordance with AS3798-2007.
5. Access to Lot 131 is via the newly constructed frontage of Bottlebrush Court.

MURRAY & ASSOCIATES



SURVEYORS & TOWN PLANNERS
ACN 075 543 154
Murray Building, 15-17 Currie St. Nambour Ph. (07)5441 2188 P.O. Box 246
Branch Offices at Caboolture Chinchilla Roma Gympie & Emerald

CADASTRAL SURVEYOR *9-157*

DISCLOSURE PLAN

Disclosure Plan for Proposed Lot 131
(Currently part of Lot 124 on SP329116)

LOCAL AUTHORITY: **GYMPIE REGIONAL COUNCIL** LOCALITY: **Pie Creek**

CLIENT: **Roberts Brothers**

DATE: 25/01/2023	SCALE @A3: 1:500
COMP 61995_ (Stage 6 Dis)	Level OPM177674
FILE: _Roberts Bros.dwg	Datum: RL89-974m AHD(D)
MAP REF: 9445-34111	ORIGINAL: POR 366
CONTOUR INT: 0.5 m	
DRAWN: AJH	JOB No: 61995/131
CHECKED: IKS	