

AERIAL IMAGE SUPPLIED BY

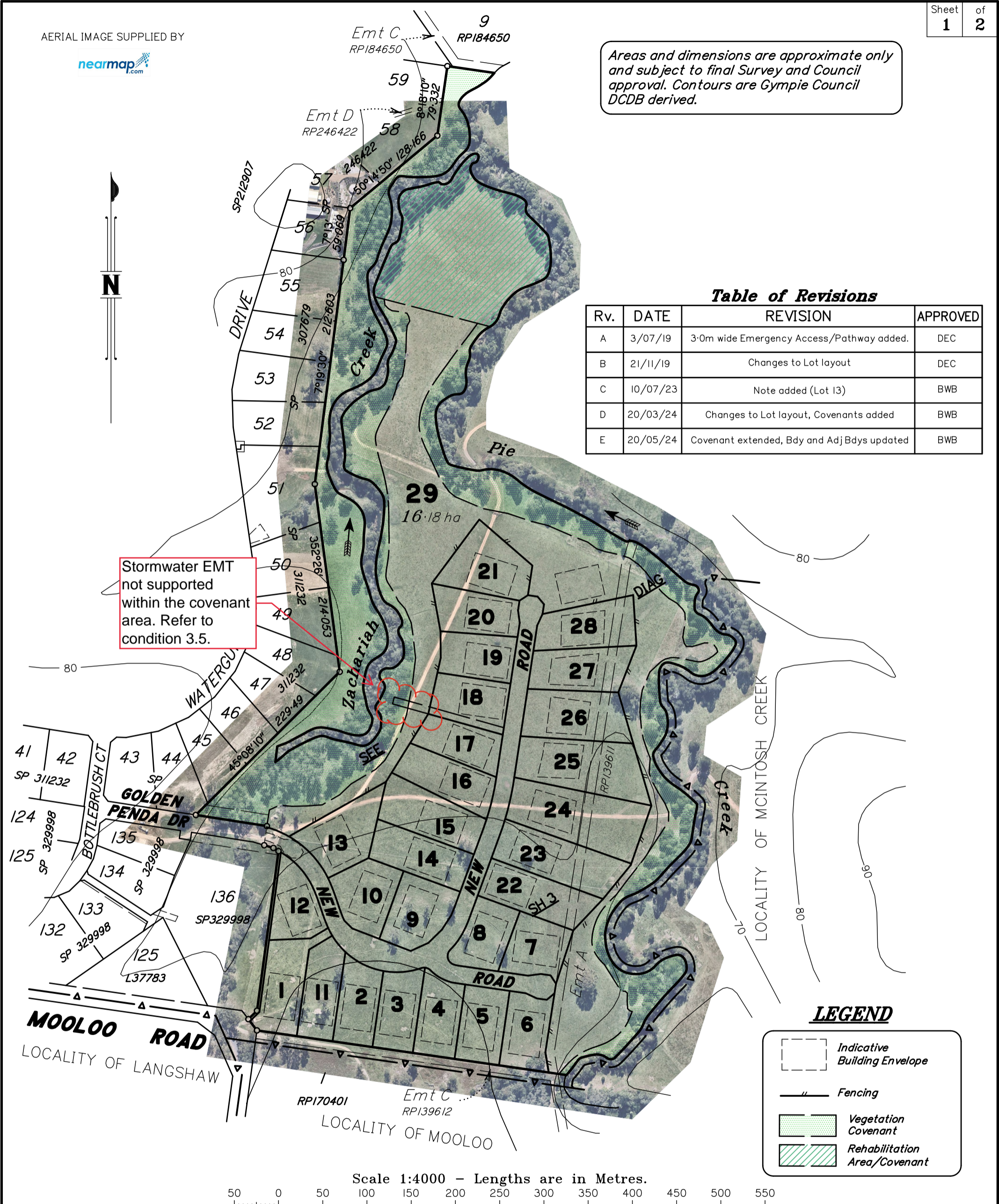

Areas and dimensions are approximate only and subject to final Survey and Council approval. Contours are Gympie Council DCDB derived.



Stormwater EMT not supported within the covenant area. Refer to condition 3.5.

**Table of Revisions**

Rv.	DATE	REVISION	APPROVED
A	3/07/19	3.0m wide Emergency Access/Pathway added.	DEC
B	21/11/19	Changes to Lot layout	DEC
C	10/07/23	Note added (Lot 13)	BWB
D	20/03/24	Changes to Lot layout, Covenants added	BWB
E	20/05/24	Covenant extended, Bdy and Adj Bdys updated	BWB

**LEGEND**

- Indicative Building Envelope
- Fencing
- Vegetation Covenant
- Rehabilitation Area/Covenant

Scale 1:4000 - Lengths are in Metres.

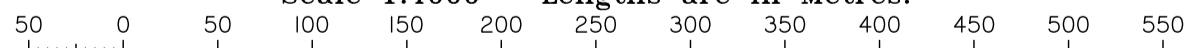

**MURRAY & ASSOCIATES**  
 SURVEYORS & TOWN PLANNERS  
 Murray Building, 15-17 Currie St. Nambour Ph. (07)5441 2188 P.O. Box 246  
 Branch Offices at Caboolture Chinchilla Roma Gympie & Emerald  
 CADASTRAL SURVEYOR

**PLAN OF DEVELOPMENT**

**Proposed Subdivision of Lot 99 on SP345311**

LOCAL AUTHORITY: **GYMPIE REGIONAL COUNCIL**

CLIENT **Roberts Bros**

LOCALITY **Pie Creek** MAP REF. **9445-31444**

DATE **4/04/2019** LEVEL DATUM **ASSUMED**

FILE **61995\_(Stage 7 E)\_Roberts.dwg**

DRAWN **LF** CHECKED **BWB** ORIGINAL **POR 99**

SCALE **1:4000** JOB No **61995/E**

**DIAGRAM**  
Scale 1:2000

AERIAL IMAGE SUPPLIED BY



Scale 1:2000 - Lengths are in Metres.

LOCALITY OF MCINTOSH

LOCALITY OF MOOLOO